

Budget, Finance and Facilities Committee

**Meeting Materials
September 2, 2020**

FLORIDA **A&M** UNIVERSITY
Board of Trustees

Budget, Finance and Facilities Committee Meeting

Wednesday, September 2, 2020

10:30 AM

Conference Call

Committee Members: Kimberly Moore, Chair
Thomas Dortch, Kelvin Lawson, Belvin Perry and Craig Reed

AGENDA

- | | | |
|-----|---------------|--------------------|
| I. | Call to Order | Trustee Moore |
| II. | Roll Call | Dr. Lynn B. Turner |

ACTION ITEMS

- | | | |
|------|--|--------------------|
| III. | Minutes from the August 14, 2020 Committee Meeting | Trustee Moore |
| IV. | Carry-forward Budget | Dr. Alan Robertson |

INFORMATION ITEMS

- | | | |
|-------|---|---------------------|
| V. | Vice President for Finance and Administration's Report | Dr. Alan Robertson |
| | a. Financial Status Report- FY 2019-2020 Preliminary Report | |
| | b. COVID-19 Expenditures Report to Date | |
| | c. Report on Inclusion of Minority and Women Owned Business Enterprises in University Procurement and Contracting | |
| | d. Project Updates – University Construction / Operations | |
| | i. Center for Access and Student Success (CASS) | |
| | ii. 700-Bed Residence Hall | |
| | iii. Central Energy Plant (CEP) | |
| | iv. Student Service Center Dining Hub | |
| | v. Student Amphitheater | |
| VI. | Duke Energy / Brooksville Update | Dr. Fred Gainous |
| VII. | Housing Facilities Update | Dr. Jennifer Wilder |
| VIII. | Adjournment | Trustee Moore |

Supplemental Document: List of Contracts over \$100,000

Action Item:

August 14, 2020 Meeting Minutes

FLORIDA **A&M** UNIVERSITY
Board of Trustees
ACTION ITEM

Budget, Finance and Facilities Committee
Wednesday, September 2, 2020
Agenda Item: III

Subject: Minutes from the August 14 2020 Committee Meeting

Proposed Board Action: In accordance with the Florida Statutes, a governing body shall prepare and keep minutes or make a tape recording of each open meeting of the body.

Attachments: Yes

1. Budget, Finance and Facilities Committee Meeting Minutes (August 14, 2020)



**Florida Agricultural and Mechanical University
Board of Trustees**

Budget, Finance, and Facilities Committee Minutes

Trustee Kimberly Moore, Committee Chair
Friday, August 14, 2020
Location: Zoom Conference Call

MINUTES

Committee Members Present: Kimberly Moore, Kelvin Lawson, Thomas Dortch, Belvin Perry, and Craig Reid

Call to Order/Roll Call

Chair Moore called the meeting to order. Dr. Turner called the roll. A quorum was present.

Prior to the committee proceeding with its agenda, Dr. Larry Robinson, University President, provided a brief status report on the student housing move-in. Dr. Robinson indicated that today was the first day of students moving into select university housing facilities. Approximately 270 students were expected to move into the Villages and Paddyfoote. Overall, the university expects 1,700 students to move into the housing facilities. A total of 76 resident assistants (RAs) were tested for COVID-19 last week and zero were found positive. The university has an outstanding reopening plan in place to keep students safe throughout this semester.

ACTION ITEMS

Approval of Minutes – June 3, 2020.

There were no revisions to the minutes.

The motion to approve this agenda item was carried.

Amendment to BOT Policy #2005-A:

Increasing Continuing Services Construction Approvals and Increasing Continuing Services Approvals for Design Services

AVP Chris Hessel presented the amendment to BOT Policy #2005-A by stating that the intention of the policy is to increase the maximum dollar amount of the continuing service contracts for construction services and design services. The revision is consistent with the amended sections 255.103(4) and 287.005, Florida Statutes. The maximum amount of continuing contracts for



construction has increased from \$2 million to \$4 million. For design services, the increase is from \$200,000 to \$500,000.

Questions/Comments re: Amendment to BOT Policy on Continuing Services Contracts

- Trustee Moore reiterated that the BOT policy amendment would ensure alignment with the Florida State statutes and that the other SUS institutions are making a similar adjustment to their policies.

The motion to approve this agenda item was carried.

Continuing Services Vendors

AVP Chris Hessel indicated that the university had solicited companies in the architectural, mechanical, civil engineering, construction management, environmental health and safety, landscaping, and structural engineering services. The vetting criteria is rigorous. The competitive bid went through the RFQ process, which was posted on April 10, 2020, and submissions by the firms due on May 5, 2020. The scoring criteria is based on past performance, experience and ability, design ability, minority business enterprise (MBE) credits, their work in progress and their experience working with Florida A&M University or other SUS institutions. The list of recommended vendors is in the committee materials.

The recommendation to the Board of Trustees was to approve the selection of proposed continuing services vendors and to authorize the President to execute the necessary contracts and agreements. These contracts would be executed after the Board approval and review and comments by the General Counsel's office.

Questions/Comments re: Continuing Services Vendors

- Trustee Moore stated that this process is one that has been followed in previous years. What it points to is the rigor that we have underway in the selection process. It includes a second phase of which, not only the BOT reviews, but also General Counsel reviews.
- Trustee Woody asked if the companies on the list are there for one year and have the opportunity for an additional year or is it a two-year period?
Response: Asst. VP Hessel indicated that there are two one-year renewal options for each company for the specified services.
- Trustee Lawson asked if this changes the dollar value of the contracts that need to come before the Board? He also wanted to make sure that it does not change certain items that have to go through the full procurement process as discussed in the past. He wants to make sure that minority and women-owned businesses had an opportunity to do business with the university and to make sure that what is being approved does not preclude our willingness to work with MWBE firms.
Response: Trustee Moore offered a general response of no it does not preclude but actually encourages it by way of our minority vendor diversity program. It does not change the fact that contracts would still move forward through the board-approved



process based on a given amount. In terms of the process, VP Robertson agreed that any contracts with construction firms, architects and engineering firms are reviewed by the Director of Facilities, the Vice President of Finance and Administration and the President. Finally, the contracts are reviewed by our internal legal counsel. Contracts up to \$1 million are signed by the President, over \$1 million require Board approval.

Response: Trustee Moore stated that this is consistent with other SUS partners, as they have already updated that amendment. Thus, the reason for inclusion with this board meeting is so that they would align with one another and would not have to go back for corrections.

- Trustee Reid requested an update on our minority business enterprise participation and rates.

Response: VP Robertson will provide a report during the September BOT meeting.

- Trustee Lawson asked that, given the previous challenges with construction in the system, a provision be put in place for items to be reviewed by the board so that they would have a line of sight as to what is being agreed upon.

Response: President Robinson clarified by reading the actual recommendation that “these contracts will be executed after the board approves, reviews and comments by the Office of General Counsel.” This is in the official motion being considered.

The motion to approve this action item was carried.

Final FY 2020-2021 University Budget

Budget Director Nichole Murry thanked the committee for having the special meeting to allow completion of the year-end processes. For the upcoming year, FAMU will receive \$13.3 million of non-recurring funds of the State’s Performance Based Funding. The university did not receive any PECO allocation to support minor repair and renovation projects. Funding for Contracts and Grants is projected to be higher due to CARES Act funding. Due to the pandemic there will be a decline in student enrollment. Subsequently, there is a projected reduction in housing and auxiliary revenues, student financial aid, technology fees, and concessions.

BOT approval of the budget is required prior to the August 21, 2020 submission of the final operating budget to the Board of Governors.

Questions/Comments re: Final FY 2020-2021 University Budget

- Trustee Harper asked how the \$13 million reserve would be used?

Response: Director Murry informed the committee that the \$13 million reserve is the performance-based funding that the university budget council has allocated to achieve University performance metrics. Trustee Moore and President Robinson also stated that the funds are being utilized to address the university’s strategic priorities.



- Trustee Lawson commented that he would like to capture the true costs that the university is incurring to manage through the pandemic. VP Robertson indicated that this would be addressed by the presentation to follow.
- Trustee Cavazos asked if raises for eligible faculty are included as this year's budget?
Response: President Robinson stated that the university submitted a request to secure legislative funds to be used for faculty increases on last year, but it was denied. The university will continue to work hard to secure legislative funds for faculty salaries.

The motion to approve this action item was carried.

INFORMATION ITEMS

Pandemic Financial Planning Scenarios

VP Robertson shared the results and strategies of a 12-week project concluded with McKinsey Consulting Group on navigating through the COVID-19 Crisis. In Mid-May, FAMU embarked on the project initiated by Dr. Robinson with McKinsey Consulting, sponsored and funded by the Thurgood Scholarship Fund. We sought to build a comprehensive cash flow model, including three specific COVID scenarios to understand the financial implications and the magnitude of potential cash impacts. It was a great opportunity to gain an outside perspective on cost saving opportunities across personnel and non-personnel expenditures.

VP Robertson stated, "At the beginning of the engagement our opening strategy was the same as Scenario 1, hybrid for the entire academic year. By the end of the engagement in early August, we had shifted to Scenario 2, hybrid in the Fall and remote for the balance of the academic year. We also forecast in Scenario 3, beginning the fall in hybrid mode and have to pivot to remote learning similar to the experience we had the last spring semester."

Finally, VP Robertson reviewed enrollment-related receipts, external receipts, and disbursements as well as the cash flow implications of each scenario. He concluded the presentation by sharing cost saving ideas, as well as revenue-generating ideas and innovation strategies with the committee.

Questions/Comments re: Pandemic Financial Planning Scenarios

- Trustee Washington asked if the 6% hold back was accounted for in the scenarios presented.
Response: VP Robertson indicated that the 6% hold back assumption was included in all three of the scenarios.

**Other**

- Trustee Dortch stated that it is critical for the university to monitor and report how well it is doing with regard MWBE firms. We need to make sure we are creating economic opportunities. Trustee Moore indicated that going forward we will regularly report on MWBE engagement and expenditures.

NOTE: In the interest of time, Trustee Moore requested that the committee forego the university construction project updates. These updates had been recently presented and will be presented at the September meeting.

The meeting was adjourned at 1:48 p.m.

DRAFT

Action Item:
Carry-forward Budget

FLORIDA **A&M** UNIVERSITY
Board of Trustees
ACTION ITEM

Wednesday, September 2, 2020

Agenda Item: IV

Subject: Carry-forward Budget

Rationale:

2019 Senate Bill 190 amended 1011.45 F.S. regarding university Education & General carryforward minimum reserve balances, reporting requirements, and allowable uses. 1011.45(2) states that "Each university that retains a state operating fund carry forward balance in excess of the 7 percent minimum shall submit a spending plan for its excess carry forward balance. The spending plan shall be submitted to the university's board of trustees for review, approval, or if necessary, amendment by September 1, 2020, and each September 1 thereafter. The Board of Governors shall review, approve, and amend if necessary, each university's carry forward spending plan by October 1, 2020, and each October 1 thereafter." 1011.45(3) adds "A university's carry forward spending plan shall include the estimated cost per planned expenditure and a timeline for completion of the expenditure."

Attachments: Yes

- 1) 2020-21 University E&G Carryforward Spending Plans-Supplemental Details (Operating Plans)
- 2) 2020-21 University E&G Carryforward Spending Plans-Supplemental Details (Fixed Capital Outlay Plans)

Florida A&M University
Education and General
Carryforward Spending Plan Summary
Approved by University Board of Trustees
Balances and Spending Plans as of July 1, 2020

	<u>University E&G</u>	<u>Special Unit or Campus (Title)</u>	<u>Grand Total : University Summary</u>
A. Beginning E&G Carryforward Balance - July 1, 2020 :			
Cash	\$ 28,140,183	\$ -	\$ 28,140,183
Investments	\$ 10,277,570	\$ -	\$ 10,277,570
Accounts Receivable	\$ 3,041,559	\$ -	\$ 3,041,559
Less: Accounts Payable	\$ 6,559,649	\$ -	\$ 6,559,649
Less: Deferred Student Tuition & Fees	\$ -	\$ -	\$ -
B. Beginning E&G Carryforward Balance (Net of Payables/Receivables/Deferred Fees) :	\$ 34,899,663	\$ -	\$ 34,899,663
C. 7% Statutory Reserve Requirement (1011.45(1) F.S.):	\$ 13,361,449	\$ -	\$ 13,361,449
D. E&G Carryforward Balance Less 7% Statutory Reserve Requirement (Amount Requiring Approved Spending Plan) :	\$ 21,538,214	\$ -	\$ 21,538,214
E. *Encumbrances			
Restricted by Appropriations	\$ 1,343,597	\$ -	\$ 1,343,597
Compliance, Audit, and Security			
Compliance Program Enhancements	\$ 1,008	\$ -	\$ 1,008
Audit Program Enhancements	\$ 10,800	\$ -	\$ 10,800
Campus Security and Safety Enhancements	\$ 73,739	\$ -	\$ 73,739
Academic and Student Affairs			
Student Services, Enrollment, and Retention Efforts	\$ 1,312,875	\$ -	\$ 1,312,875
Student Financial Aid	\$ 9,170	\$ -	\$ 9,170
Faculty/Staff, Instructional and Advising Support and Start-up Funding	\$ -	\$ -	\$ -
Faculty Research and Public Service Support and Start-Up Funding	\$ -	\$ -	\$ -
Library Resources	\$ 95,826	\$ -	\$ 95,826
Facilities, Infrastructure, and Information Technology			
Utilities	\$ 570,833	\$ -	\$ 570,833
Information Technology (ERP, Equipment, etc.)	\$ 1,372,362	\$ -	\$ 1,372,362
Minor Carryforward Fixed Capital Outlay Projects (Board of Governors Regulation 14.003(2))	\$ 2,092,997	\$ -	\$ 2,092,997
Major Carryforward Fixed Capital Outlay Projects (Board of Governors Regulation 14.003(2))	\$ -	\$ -	\$ -
Other UBOT Approved Operating Requirements			
Coronavirus/COVID-19 Related Expenditures (Should agree with encumbrances column total on "Details - Covid-19" tab)			\$ -
Other Operating Requirements (University Board of Trustees-Approved That Support the University Mission)	\$ 1,520,718	\$ -	\$ 1,520,718
Operating Encumbrances : (Should agree with encumbrances column totals on "Details-Operating" tab)	\$ 6,310,928	\$ -	\$ 6,310,928
FCO Encumbrances : (Should agree with encumbrances column totals on "Details-Fixed Capital Outlay" tab)	\$ 2,092,997	\$ -	\$ 2,092,997
Coronavirus/COVID-19 Encumbrances: (Should agree with encumbrances column totals on "Details - COVID-19" tab)	\$ -	\$ -	\$ -
Grand Total Encumbrances :	\$ 8,403,925	\$ -	\$ 8,403,925
F. * Restricted / Contractual Obligations			
Restricted by Appropriations	\$ 2,091,078	\$ -	\$ 2,091,078
University Board of Trustees Reserve Requirement	\$ -	\$ -	\$ -
Restricted by Contractual Obligations :			
Compliance, Audit, and Security			
Compliance Program Enhancements	\$ -	\$ -	\$ -
Audit Program Enhancements	\$ -	\$ -	\$ -
Campus Security and Safety Enhancements	\$ -	\$ -	\$ -
Academic and Student Affairs			
Student Services, Enrollment, and Retention Efforts	\$ 129,791	\$ -	\$ 129,791
Student Financial Aid	\$ 2,967,603	\$ -	\$ 2,967,603
Faculty/Staff, Instructional and Advising Support and Start-up Funding	\$ -	\$ -	\$ -
Faculty Research and Public Service Support and Start-Up Funding	\$ -	\$ -	\$ -
Library Resources	\$ -	\$ -	\$ -
Facilities, Infrastructure, and Information Technology			
Utilities	\$ 902,416	\$ -	\$ 902,416
Information Technology (ERP, Equipment, etc.)	\$ 43,246	\$ -	\$ 43,246
Minor Carryforward Fixed Capital Outlay Projects (Board of Governors Regulation 14.003(2))	\$ 2,738,210	\$ -	\$ 2,738,210
Major Carryforward Fixed Capital Outlay Projects (Board of Governors Regulation 14.003(2))	\$ -	\$ -	\$ -
Other UBOT Approved Operating Requirements			
Coronavirus/COVID -19 Related Expenditures (Should agree with restricted column total on "Details - Covid-19" tab)	\$ -	\$ -	\$ -

Florida A&M University
Education and General
Carryforward Spending Plan Summary
Approved by University Board of Trustees
Balances and Spending Plans as of July 1, 2020

	University E&G	Special Unit or Campus (Title)	Grand Total : University Summary
Other Operating Requirements (University Board of Trustees-Approved That Support the University Mission)	\$ -	\$ -	\$ -
Contingencies for a State of Emergency Declared by the Governor (SB 72)	\$ -	\$ -	\$ -
Operating Restricted : (Should agree with restricted column totals on "Details-Operating" tab)	\$ 6,134,134	\$ -	\$ 6,134,134
FCO Restricted : (Should agree with restricted column totals on "Details-Fixed Capital Outlay" tab)	\$ 2,736,335	\$ -	\$ 2,736,335
Coronavirus/COVID-19 Restricted : (Should agree with restricted column totals on "Details - COVID-19" tab)	\$ -	\$ -	\$ -
Grand Total Restricted / Contractual Funds :	\$ 8,870,469	\$ -	\$ 8,870,469
G. * Commitments			
Compliance, Audit, and Security			
Compliance Program Enhancements	\$ -	\$ -	\$ -
Audit Program Enhancements	\$ -	\$ -	\$ -
Campus Security and Safety Enhancements	\$ -	\$ -	\$ -
Academic and Student Affairs			
Student Services, Enrollment, and Retention Efforts	\$ -	\$ -	\$ -
Student Financial Aid	\$ -	\$ -	\$ -
Faculty/Staff, Instructional and Advising Support and Start-up Funding	\$ -	\$ -	\$ -
Faculty Research and Public Service Support and Start-Up Funding	\$ -	\$ -	\$ -
Library Resources	\$ -	\$ -	\$ -
Facilities, Infrastructure, and Information Technology			
Utilities	\$ -	\$ -	\$ -
Information Technology (ERP, Equipment, etc.)	\$ -	\$ -	\$ -
Minor Carryforward Fixed Capital Outlay Projects (Board of Governors Regulation 14.003(2))	\$ -	\$ -	\$ -
Major Carryforward Fixed Capital Outlay Projects (Board of Governors Regulation 14.003(2))	\$ -	\$ -	\$ -
Other UBOT Approved Operating Requirements			
Coronavirus/COVID-19 Related Expenditures (Should agree with committed column total on "Details - Covid-19" tab)	\$ -	\$ -	\$ -
Other Operating Requirements (University Board of Trustees-Approved That Support the University Mission)	\$ -	\$ -	\$ -
Contingencies for a State of Emergency Declared by the Governor (SB 72)	\$ 4,255,667	\$ -	\$ 4,255,667
Operating Commitments : (Should agree with committed column total on "Details-Operating" tab)	\$ 4,255,667	\$ -	\$ 4,255,667
FCO Commitments : (Should agree with committed column total on "Details-Fixed Capital Outlay" tab)	\$ -	\$ -	\$ -
Coronavirus/COVID-19 Commitments : (Should agree with committed column totals on "Details - COVID-19" tab)	\$ -	\$ -	\$ -
Grand Total Commitments :	\$ 4,255,667	\$ -	\$ 4,255,667
H. Available E&G Carryforward Balance as of July 1, 2020 :	\$ 8,153	\$ -	\$ 8,153

* Please provide supplemental **detailed descriptions** for these multiple-item categories in sections E, F, and G for operating, fixed capital outlay, and COVID-19 spending plans using Board of Governors templates provided (use worksheet tabs for "Details" included with this file).

Notes :

- Florida Polytechnic University amounts include the Phosphate Research Trust Fund.
- 2019 Senate Bill 190 amended 1011.45 F.S.** regarding university Education & General carryforward minimum reserve balances, reporting requirements, and allowable uses. 1011.45(2) states that "Each university that retains a state operating fund carry forward balance in excess of the 7 percent minimum shall submit a spending plan for it's excess carry forward balance. The spending plan shall be submitted to the university's board of trustees for review, approval, or if necessary, amendment by September 1, 2020, and each September 1 thereafter. The Board of Governors shall review, approve, and amend if necessary, each university's carry forward spending plan by October 1, 2020, and each October 1 thereafter." 1011.45(3) adds "A university's carry forward spending plan shall include the **estimated cost per planned expenditure and a timeline for completion of the expenditure.**" Three additional tabs are provided with this file to allow reporting of university detailed expenditure plans for each planned expenditure or project, a completion timeline, and amount budgeted for expenditure during the reporting fiscal year.

FLORIDA A&M UNIVERSITY
2020-2021 University E&G Carryforward Spending Plans - Supplemental Details (Operating Plans)
Pursuant to 1011.45, Florida Statutes
July 1, 2020

Line Item #	Carryforward Spending Plan Category	Specific Expenditure/Project Title	Budget				Project Timeline			Comments/Explanations
			Total Amount to be Funded from Current Year E&G Carryforward Balance	ENCUMBRANCES <small>Encumbrances Balance as of July 1, 2020</small>	RESTRICTED <small>Restricted Balance as of July 1, 2020</small>	COMMITTED <small>Committed Balance as of July 1, 2020</small>	E&G Carryforward Amount Budgeted for Expenditure During FY21	Total # Years of Expenditure per Project	Current Expenditure Year #	
1.	Restricted by Appropriations	Performance Based Funding, Black Male College Explorers, World Class and Professional Degree	3,434,675	1,343,597	2,091,078	-	-			
2.	Compliance Program Enhancements	Compliance Software Enhancements	1,008	1,008	-	-	-			
3.	Audit Program Enhancements	Audit Program System Enhancements	10,800	10,800	-	-	-			
4.	Campus Security and Safety Enhancements	Additional Security Equipment	73,739	73,739	-	-	-			
5.	Student Services, Enrollment, and Retention Efforts	Retention and Enrollment Expenses	1,442,666	1,312,875	129,791	-	-			
6.	Student Financial Aid	Financial Aid	2,976,773	9,170	2,967,603	-	-			
7.	Library Resources	Library Resources	95,826	95,826	-	-	-			
8.	Utilities	Utilities	1,473,249	570,833	902,416	-	-			
9.	Information Technology (ERP, Equipment, etc.)	Information Technology Equipment	1,415,608	1,372,362	43,246	-	-			
10.	Other Operating Requirements (University Board of Trustees-Approved That Support the University Mis		1,040,214	1,040,214	-	-	-			
11.	Contingencies for a State of Emergency Declared by the Governor					4,255,667	4,255,667			
12.										
13.										
14.										
15.										
16.										
17.										
18.										
19.										
Total as of July 1, 2020: *			\$ 11,964,558	\$ 5,830,424	\$ 6,134,134	\$ 4,255,667	\$ 4,255,667			

*Note: Should agree with respective encumbrances, restricted/contractual, or committed category totals on "Summary" tab.

FLORIDA A&M UNIVERSITY
2020-2021 University E&G Carryforward Spending Plans - Supplemental Details (Fixed Capital Outlay Plans)
Pursuant to 1011.45, Florida Statutes
July 1, 2020

Line Item #	Carryforward Spending Plan Category	Specific Project Title/Name	Description	Project(s) Cost to be Funded from Current Year E&G Carryforward Balance	Encumbrances			E&G Carryforward Funds Budgeted for Expenditure During FY21	Carryforward Expenditure Timeline			Comments/Explanations
					Encumbrances Balance As of July 1, 2020	Restricted Balance As of July 1, 2020	Committed Balance As of July 1, 2020		Total # Years of Expenditure per Project	Current Expenditure Year #	Estimated Completion Date (Fiscal Year)	
1	Minor, < \$2M: Renovation, Repair or Maintenance	Campus Wide Water and Sewer Improvements	Improvement Water and Sewer Lines	\$859,837	\$673,173	\$186,664	\$0	\$0	3	2	2022	
2	Minor, < \$2M: Renovation, Repair or Maintenance	Roofing	Repair Roofs on Campus	\$769,950	\$597,685	\$172,265	\$0	\$0	2	2	2021	
3	Minor, < \$2M: Renovation, Repair or Maintenance	Research Equipment Replacement		\$575	\$575	\$0	\$0	\$0	2	2	2021	
4	Minor, < \$2M: Renovation, Repair or Maintenance	Steam Building Connection & Distribution Repairs	Repair Building steam connections and distribution lines	\$44,584	\$9,856	\$34,728	\$0	\$0	2	2	2021	
5	Minor, < \$2M: Renovation, Repair or Maintenance	Second Return Well	Repair the Second Return well at Chiller Plant	\$817,275	\$51,190	\$766,085	\$0	\$0	3	2	2022	
6	Minor, < \$2M: Renovation, Repair or Maintenance	Building Boiler Replacement	Replace buidling boilers	\$215,086	\$115,399	\$99,687	\$0	\$0	2	2	2021	
7	Minor, < \$2M: Renovation, Repair or Maintenance	Steam Distribution Repairs	Repair steam distribution lines	\$1,342	\$1,300	\$42	\$0	\$0	2	2	2021	
8	Minor, < \$2M: Renovation, Repair or Maintenance	5 Year Inspection of Fire Alarm System	Required inspteciton for compliance	\$75,000	\$0	\$75,000	\$0	\$0	2	2	2021	
9	Minor, < \$2M: Renovation, Repair or Maintenance	Fire Alarm System Upgrades	Upgrade fire alarm systems on campus	\$500,000	\$340,955	\$159,045	\$0	\$0	2	2	2021	
10	Minor, < \$2M: Renovation, Repair or Maintenance	Smart Classroom Upgrades	Upgrade classrooms and learning environments with smart technology	\$374,215	\$0	\$374,215	\$0	\$0	2	2	2021	
11	Minor, < \$2M: Renovation, Repair or Maintenance	2020 Full Master Plan	Master Plan Update	\$300,000	\$0	\$300,000	\$0	\$0	2	2	2021	
12	Minor, < \$2M: Renovation, Repair or Maintenance	Sidewalk Repair & Replacement	Repair and Replace sidewalks on campus	\$155,000	\$10	\$155,000	\$0	\$0	2	2	2021	
13	Minor, < \$2M: Renovation, Repair or Maintenance	Wayfinding Signage	Install directional signage on campus and in buildings	\$146,609	\$133,232	\$13,377	\$0	\$0	2	2	2021	
14	Minor, < \$2M: Renovation, Repair or Maintenance	Infrastructure Building Repair	Minor	\$330,676	\$86,370	\$244,306	\$0	\$0	2	2	2021	
15	Minor, < \$2M: Renovation, Repair or Maintenance	Lawson Seating Repairs	Repairs seating in Lawson Center	\$30,115	\$29,901	\$214	\$0	\$0	2	2	2021	
16	Minor, < \$2M: Renovation, Repair or Maintenance	Lee Hall Improvement & Upgrades	Repairs and upgrades to Lee Hall lighting and AV Equipment	\$84,058	\$53,351	\$30,708	\$0	\$0	2	2	2021	
17	Minor, < \$2M: Renovation, Repair or Maintenance	Fall Protection Systems	Installation and Repair to Fall Protection Systems	\$125,000	\$0	\$125,000	\$0	\$0	2	2	2021	
* Total Minor Carryforward As July 1, 2020 :				\$4,829,322	\$2,092,997	\$2,736,336	\$0	\$0				

Major Carryforward Projects (>\$2M)¹

5	\$0	\$0	\$0	\$0	\$0
6	\$0	\$0	\$0	\$0	\$0
7	\$0	\$0	\$0	0	\$0
* Total Major Carryforward As July 1, 2020 :				\$0	\$0

1. As defined in Board of Governors Regulation 14.003(2).

Fixed Capital Outlay Totals :	\$4,829,322	\$2,092,997	\$2,736,336	\$0	\$0
--------------------------------------	--------------------	--------------------	--------------------	------------	------------

* Note: Should agree with respective encumbrances, restricted/contractual, or committed category totals on "Summary" tab.

**State University System
Education & General Carryforward Spending Plan
Reporting Definitions**

I. Carryforward Spending Plan - Budgetary Category Definitions

1.	Encumbrances	Unpaid balances remaining in active purchase orders, travel authorizations, etc., to be paid using E&G carryforward funds. May also include nonrecurring employee compensation amounts through the end of the current fiscal year.
2.	7% Statutory Reserve Requirement	Required E&G reserve requirement per 1011.45 F.S. - amends previous 1011.40 F.S. requirement. Based on percentage of state operating budget.
3.	Restricted/Contractual Obligations	Should generally be supported by documentation that memorializes an agreement with another party (e.g. contract, offer letter, construction contract/project number, etc.).
4.	Commitments	Monies designated for a specific purpose which are not yet encumbered/contracted/restricted. Discretion may still be exercised with respect to the use of these funds.
5.	University Board of Trustees Reserve Requirement	The amount of unrestricted funds set aside by the University Board of Trustees to address critical, unforeseen, or non-discretionary items that require immediate funding, such as unanticipated or uninsured catastrophic events, unforeseen contingencies, state budget shortfalls, or university revenue shortfalls.
6.	Restricted by Appropriations	Funds appropriated by the Legislature for a specific purpose or intended use as identified by law or through legislative work papers.
7.	Compliance Program Enhancements	Initiatives associated with being in compliance with federal law, state law, Board of Governors Regulations or any other entity with which the University must comply.
8.	Audit Program Enhancements	Initiatives associated with implementing audit programs of the institution.
9.	Campus Security and Safety Enhancements	The support of campus security and/or safety issues, such as the recruitment of police officers, vehicles, equipment, and investments which promote security and safety at the institution. This issue may also include mental health counseling and services.
10.	Student Services, Enrollment, and Retention Efforts	Funds to promote student success through supporting student services programs, addressing enrollment, and assisting with retention efforts to support timely graduation.
11.	Student Financial Aid	Funds allocated to reduce student costs and to provide an opportunity to obtain a degree in an affordable and timely fashion.
12.	Faculty/Staff Instructional and Advising Support and Start-Up Funding	Funds identified to support instructional and advising activities, and/or start-up packages for new faculty. Start-up packages are often expended over a multi-year period.
13.	Faculty Research and Public Service Support and Start-Up Funding	Funds identified to support research and public service, and any associated start up funding- Start-up packages are often expended over a multi-year period.
14.	Library Resources	Materials and database access required to support programs of study and research.
15.	Utilities	Support of nonrecurring utility costs throughout the university.
16.	Information Technology (ERP, Equipment, Etc.)	Funds to improve operational productivity, educational improvements, and technological innovation, implementation and/or maintenance of ERP systems, and technological equipment purchases.
17.	Other Operating Requirements	Other expenditures/projects that support the university's mission, are nonrecurring in nature, and are approved by the university board of trustees.
18.	Contingencies for a State of Emergency Declared by the Governor	A commitment of funds to a contingency reserve for expenses incurred as a result of a state of emergency declared by the Governor pursuant to s. 252.36, Florida Statutes.

**State University System
Education & General Carryforward Spending Plan
Reporting Definitions**

- | | |
|---|---|
| 19. PECO Projects - Supplemental Funds to Complete Projects That Received Previous Appropriation | Commitment of funds to a public education capital outlay project for which an appropriation has previously been provided that requires additional funds for completion and which is included in the list required by s. 1001.706(12)(d), Florida Statutes. This category is valid for both major and minor carryforward projects. |
| 20. Completion of Renovation, Repair, or Maintenance Project up to \$5M | For projects that are consistent with the provisions of s. 1013.64(1), Florida Statutes, up to \$5 million per project. Refer to Board of Governors Regulation 14.001 for the definitions of renovation, repair, and maintenance. This category is valid for both major and minor carryforward projects. |
| 21. Replacement of Minor Facility (< 10,000 gsf) up to \$2M | Replacement of minor facility project that does not exceed 10,000 gross square feet in size, up to \$2 million. This category is valid for minor carryforward projects. |
| 22. Completion of a Survey-Recommended Remodeling or Infrastructure Project (Including DRS Schools) up to \$10M | Completion of a remodeling or infrastructure project, including a project for a developmental research school, up to \$10 million per project, if such project is survey recommended pursuant to s. 1013.31, Florida Statutes. Refer to Board of Governors Regulation 14.001 for the definition of remodeling. This category is valid for both major and minor carryforward projects. |

II. Column Definitions for Use With Details Tabs

- | | |
|---|---|
| 1. Carryforward Spending Plan Category | Functional category brought forward from the Carryforward Spending Plan reporting template. Categories are defined in Section I of this document. |
| 2. Specific Expenditure/ Project Title/Name | Detailed title of planned expenditure item or project, with sufficient details to be tracked individually through the expenditure cycle to completion. |
| 3. Total Amount to be Funded from Current Year E&G Carryforward Balance | The total estimated cost to be paid from current-year beginning E&G carryforward balance for the specific expenditure item or project. |
| 4. E&G Carryforward Amount Budgeted for Expenditure During FY21 | This column represents the current budgetary year's estimated disbursement of E&G carryforward towards the total planned expenditure item or project. |
| <u>Project Timeline</u> | |
| 5. Estimated Completion Date | Estimated date (year) for full expenditure of E&G carryforward funds for the specific expenditure plan item or project. |
| 6. Current Expenditure Year # | The current year in the project completion timeline, e.g. year 2 of a 4 year project. Input is number only. |
| 7. Total # Years of Expenditure per Project | The total number of years over which the expenditure item / project will span. |
| 8. Comments/Explanations | Additional information to assist the user of the report including, but not limited to, a description of the expenditure item / project and how it supports the university's mission and operations. |

Other Definitions

- | | |
|--------------------------|--|
| 9. Nonrecurring | Nonrecurring guidelines as vetted and approved by the Council for Administrative and Financial Affairs (CAFA) can be found on the Board of Governors' website. |
| 10. Coronavirus/COVID-19 | The use of E&G carryforward funds to address various university costs associated with COVID-19. |

insert University name here
FIXED CAPITAL OUTLAY BUDGET for Fiscal Year 2020-21
 As of July 1, 2020
 (reference: Section 1013.61, F.S. and Board Reg. 14.003)

CFSP item #	Category	Project Title/Name	Description	Total Project(s) Cost	Funding Source(s)		Funds Expended to Date	Funds to be Expended this Year	Remaining Balance	Project Timeline		Comments
					Source	Amount				Start Date	Completion Date	
Education & General (E&G) Operating Projects												
	<i>Consolidated line item of all FCO/capitalized projects funded from E&G operating funds, pursuant to Board regulations 14.003(2)(a) and 9.001. No individual project exceeds \$1M. This is a single line item in both Operating and FCO budgets.</i>			\$0	E&G Operating Funds	\$0	\$0	\$0	\$0		Not Applicable	These are current year funds to be spent in the current year.
Minor Carryforward (CF) Projects												
	<i>Consolidated line item of all FCO projects with a cost of less than \$2M funded from E&G CF funds, pursuant to Board regulation 14.003(2)(b). Includes replacement of facilities less than 10,000 gross sf. This is a single line item in both Operating and FCO budgets. For a detailed listing of projects, refer to the E&G Carryforward Spending Plan (CFSP).</i>			\$6,111,690	E&G CF Funds	\$6,111,690	\$1,282,358	\$2,092,997	\$2,736,336		Refer to detail in Carryforward Spending Plan	
Major Carryforward (CF) Projects												
	<i>Any FCO project funded in whole or in part from CF funds, where total individual FCO project cost exceeds \$2M, pursuant to Board regulation 14.003(2)(c).</i>											
5				\$0		\$0	\$0	\$0	\$0			
6				\$0		0 0 \$0	\$0	\$0	\$0			
7				\$0		0 0 \$0	\$0	\$0	\$0			
State Appropriated Projects												
	<i>Pursuant to Board Regulation 14.003(12)(d). All FCO projects using funds originally appropriated as FCO funds by the State of Florida, notwithstanding criteria in Board regulation 14.001. Never to be included in the operating budget. Examples, PECO and CITF.</i>											
	Renovation of Softball Field	Renovation of Softball field to add turf field and netting to complex		\$379,750	CITF	\$379,750	\$0	\$379,750	\$0			
	Amphitheater Sidewalk	Installation of Sidewalk for access to Amphitheater and improved aesthetics		\$100,000	CITF	\$100,000	\$19,575	\$2,175	\$78,250			
	Golf Driving Range	Installation of Driving Range for the Campus Recreational Center		\$63,915	CITF	\$63,915	\$0	\$63,915	\$0			
	Student Activities Capital Improvement	Office of Student Activities Storage Unit and Capital Improvements		\$125,000	CITF	\$125,000	\$0	\$0	\$125,000			
	Student Organization Warehouse	Construction of Student Organization Warehouse on Gamble Street		\$621,000	CITF	\$621,000	\$0	\$0	\$621,000			
	Campu Rec Ctr Parking Lot			\$275,000	CITF	\$275,000	\$0	\$0	\$275,000			
	Trio Building Renovation			\$300,000	CITF	\$300,000	\$0	\$0	\$300,000			
	CC Cunningham Renovation/Patio			\$350,893	CITF	\$350,893	\$0	\$0	\$350,893			
	Commons Reno Eng/Tech			\$75,000	CITF	\$75,000	\$0	\$0	\$75,000			
	2nd Floor Gove Assoc Student Union			\$100,000	CITF	\$100,000	\$0	\$0	\$100,000			
	Student Affairs Building (CASS)			\$41,000,000	PECO General Revenue	37,500,000 3,500,000	\$23,992,261	\$17,007,739	\$0			
					Total:	\$41,000,000						
Non-Appropriated Projects												
	<i>Pursuant to Board Regulation 14.003(12)(e). All FCO projects that have not directly or indirectly used funds appropriated by the State. Examples include private donations, athletic revenues, federal grants, housing/parking revenue bonds, etc.</i>											
	Amphitheater Canopy	Amphitheater Canopy Donation		\$500,000	Donations	500,000 0 \$500,000	\$57,917	\$442,083	\$0			
	700 Bed Housing	700 Bed Dormitory		\$60,058,867	HBCU Finance Grant	58,430,770 1,628,097 \$60,058,867	\$58,337,587	\$1,721,280	\$0			
	700 Bed Dining Hub	Dinning Facility Near 700 Bed Dormitory		\$11,185,891	Metz Donation HBCU Finance Grant Housing Aux Bus Svc Aux	1,500,000 1,569,230 316,661 2,500,000 5,300,000 \$11,185,891	\$3,948,943	\$7,236,948	\$0			
				TOTALS:		\$121,247,006	\$47,991,440	\$87,638,640	\$28,946,887	\$4,661,479		

Notes:
 Pursuant to Regulation 14.003(3), Fixed Capital Outlay projects do not apply to those projects acquired, constructed, and owned by a Direct Support Organization or under a Public Private
 The Fixed Capital Outlay Budget may be amended, subject to the requirements described in Regulation 14.003(4).

Information Item:

Vice President for Finance and Administration's Report

FLORIDA **A&M** UNIVERSITY
Board of Trustees
INFORMATION ITEM

Budget, Finance and Facilities Committee

Wednesday, September 2, 2020

Agenda Item: V

Subject: Vice President for Finance and Administration's Report

Background Information and Summary: Dr. Alan Robertson, Vice President for Finance and Administration and Chief Financial Officer, will provide information on the following items:

- a. Financial Status Report- FY 2019-2020 Preliminary Report
- b. COVID-19 Expenditures Report to Date
- c. Report on Inclusion of Minority and Women Owned Business Enterprises in University Procurement and Contracting
- d. Project Updates – University Construction / Operations
 - i. Center for Access and Student Success (CASS)
 - ii. 700-Bed Residence Hall
 - iii. Central Energy Plant (CEP)
 - iv. Student Service Center Dining Hub
 - v. Student Amphitheater

Information Item:

Vice President for Finance and Administration's Report

- a) Financial Status Report – FY 2020-2021 Preliminary Report

FLORIDA A&M UNIVERSITY				
Financial Status FY19-20				
Fund Name	FY2019-2020 Approved Budget	Encumbrances and Expenditures PeopleSoft as of 06/26/2020	Budget Status (Over) Under	Percent of Budget Expended %
	-1-	-2-	-3-	-4-
Education and General				
Total Educational and General	\$ 190,942,553	\$ 176,886,347	\$ 14,056,206	93%
Auxiliary Enterprises				
Total Auxiliary Enterprises	\$ 62,468,692	\$ 39,792,065	\$ 22,676,627	64%
Total Intercollegiate Athletics	\$ 10,231,120	\$ 9,016,439	\$ 1,214,681	88%
Total Concessions	\$ 241,309	\$ 153,687	\$ 87,622	64%
Total Technology Fee	\$ 2,359,202	\$ 1,281,324	\$ 1,077,878	54%
Student Activities				
Total Student Activities	\$ 4,089,483	\$ 3,921,180	\$ 168,303	96%
Student Financial Aid				
Total Financial Aid	\$ 48,160,117	\$ 44,775,092	\$ 3,385,025	93%
Contracts & Grants				
Total Contracts and Grants	\$ 65,889,895	\$ 59,023,987	\$ 6,865,908	90%
Grand Total	\$ 384,382,371	\$ 334,850,121	\$ 49,532,250	87%
*KEY ASSUMPTIONS				
*Salaries are encumbered for 12 months				

Information Item:

Vice President for Finance and Administration's Report

- b) COVID-19 Expenditures Report to Date

Florida A&M University
Schedule of Expenditures
Cares Act Funding - COVID-19
as of July 31, 2020

	Budget	Encumbrance	Expense	Balance
Phase 1- Student Aid	6,525,663.00		6,209,573.00	316,090.00
Phase 2- Institutional Aid	6,525,662.00	1,296,864.88	5,228,797.12	-
Total	13,051,325.00	1,296,864.88	11,438,370.12	316,090.00

Information Item:

Vice President for Finance and Administration's Report

- c) Report on Inclusion of MWBE in University Procurement and Contracting

MINORITY BUSINESS EXPENDITURE REPORT
Fiscal Year 2020

<i>Classification</i>	Commodity		Arch. & Eng.		Construction		Services		Total Expenditures	
	Count	Total	Count	Total	Count	Total	Count	Total	Count	Total
<i>African-American</i>	41	\$ 1,447,966	-	-	2	\$ 3,637	169	\$ 2,443,655	212	\$ 3,895,258
<i>Hispanic</i>	2	4,775	-	-	-	-	1	195	3	4,970
<i>Asian-Hawaiian</i>	-	-	-	-	-	-	-	-	-	-
<i>Native American</i>	-	-	-	-	-	-	-	-	-	-
<i>American Woman</i>	181	239,819	-	-	-	-	203	156,445	384	396,264
Certified MBE - Sub Total:	224	\$ 1,692,560	-	-	2	\$ 3,637	373	\$ 2,600,295	599	\$ 4,296,492
Total University Spend	7,563	\$ 15,046,297	16	\$ 708,355	83	\$ 9,487,759	7,378	\$ 26,517,659	15,040	\$ 51,760,070
MWBE Percentage Total	2.96%	11.25%	0.00%	0.00%	2.41%	0.04%	5.06%	9.81%	3.98%	8.30%

FAMU Facilities Planning and Construction MBE/WBE Tracker Fiscal Year 2019-2020

MBE/WMBE Vendors	Total Minor Proj. Budget of \$375,000.00	Project Budget	Percentage of Work
305 BROTHERS ALL IN ONE, LLC		\$29,000.00	8%
DATA SET READY		\$99,740.05	27%
FLORIDA DEVELOPERS, INC. OF TALLAHASSEE		\$21,327.48	6%
PYRAMID CONSTRUCTION & DESIGN, INC		\$8,900.00	2%
SEVEN HILLS COMMERCIAL CLEANING & PAINTING		\$11,290.00	3%
SUPREME LAWN CARE & DEBRIS REMOVAL, LLC		\$18,050.00	5%
Total Value of Work	\$375,000.00	\$188,307.53	50%
Phase 1A Housing Project MBE/WBE Allocation	Total Construction Budget \$55,725,587	Project Scope of work Budget	Percentage of Work
CTG Developer at Risk Contract Value W/O Fee		\$3,487,000.00	6%
Finrock MBE/WBE Vendors Per MBE Report		\$2,079,328.00	4%
Genterra/KCS MBE/WBE Vendors Per MBE Report		\$345,654.63	1%
Total MBE/WBE	\$55,725,587.00	\$5,911,982.63	11%
Dining Project MBE/WBE Allocation	Total Construction Budget \$8,476,333	Project Scope of work Budget	Percentage of Work
ConTech Construction		\$887,208.00	10%
Shaffield Building Specialties		\$1,192,120.00	14%
Fletcher Enterprises, Inc.		\$951,900.00	11%
Total MBE/WBE	\$8,476,333.00	\$3,031,228.00	36%
FAMU- Student Affairs Center for Access and Student Success (CASS) Project MBE/WBE Allocation	Total Value of Sub Contractors Construction cost \$24,714,893	Project Scope of work Budget	Percentage of Work
Overall Minority Vendors Participation		\$1,792,962.00	7.3%
Total MBE/WBE	\$24,714,893.00	\$1,792,962.00	7.3%

Information Item:

Vice President for Finance and Administration's Report

- d) Project Updates- University Construction / Operations

Major Capital Projects Update

- ❖ **Center for Access and Student Success (CASS)**
- ❖ **700 Bed Residence Hall**
- ❖ **Central Energy Plant (CEP)**
- ❖ **FAMU Student Service Center Dining Hub**
- ❖ **Student Amphitheater**

Center for Access and Student Success (CASS)



Center for Access and Student Success (CASS)

Project Status Report:		Budget: \$41,000,000	Date: 8/20/2020	
Project #:	Project Name:	University Project Manager:	Project Status: Material Delay	
BRFM 337	Center for Access and Student Success	David Rosenfeld/Craig Talton		
Design Status (% Complete):	Designer:	Substantial Completion Date:		
100%	JRA Architects	Nov 10, 2020		
Construction Status (% Complete):	Contractor:	Occupancy Date:		
72%	Ajax Construction	Dec 31, 2020		
Timely Completion Risk:		COVID-19, Material Delivery		
Mitigation Strategy:		Contractors Following State & Federal Guidelines		
Project Contracts:	Expenses:	Encumbrances:	Remaining:	
\$41,000,000	\$23,990,746	\$13,467,342	\$3,561,912	

700-Bed Residence Hall



700 Bed Residence Hall

Project Status Report:		Budget: \$55,850,825	Date: 8/20/2020	
Project #:	Project Name:	University Project Manager:	Project Status: On Time	
BRFM 343	700 Bed Residence Hall	David Rosenfeld/Craig Talton		
Design Status (% Complete):	Designer:	Substantial Completion Date:		
100%	Finrock Design Inc.	July 27, 2020		
Construction Status (% Complete):	Contractor:	Occupancy Date:		
100%	Construct Two Group (CTG)	August 11, 2020		
Timely Completion Risk:				
Mitigation Strategy:				
Project Contracts:	Expenses:	Encumbrances:	Remaining:	
\$55,850,825	\$50,180,510	\$5,670,315	-	

Central Energy Plant (CEP)



Central Energy Plant (CEP)

Project Status Report:		Budget: \$3,363,348	Date: 8/20/2020	
Project #:	Project Name:	University Project Manager:	Project Status:	
BRFM 343	Central Energy Plant	David Rosenfeld		
Design Status (% Complete):	Designer:	Substantial Completion Date:		
100%	Pinnacle Engineering Group	March 30, 2020		
Construction Status (% Complete):	Contractor:	Occupancy Date:		
100%	Lang Mechanical Inc.	April 30, 2020		
Timely Completion Risk: Mitigation Strategy:				
Project Contracts:	Expenses:	Encumbrances:	Remaining:	
\$3,364,614	\$3,182,326	\$182,288	-	

Student Service Center Dining Hub



Student Service Center Dining Hub

Project Status Report:		Budget: \$10,869,230	Date: 8/20/2020	
Project #:	Project Name:	University Project Manager:	Project Status: On track with revised schedule	
BRFM 343	Student Dining Facility	Elston Peets		
Design Status (% Complete):	Designer:	Substantial Completion Date:		
100%	Andy Share and Associates	Oct 30, 2020		
Construction Status (% Complete):	Contractor:	Occupancy Date:		
27%	CTG/Genterra	Nov 30, 2020		
Timely Completion Risk:		Severe weather, equipment delivery, COVID-19.		
Mitigation Strategy:		Developer will work with Auxiliary Services, Metz and Genterra weekly to reduce the risk associated with long lead time equipment.		
Project Contracts:	Expenses:	Encumbrances:	Remaining:	
\$10,869,230	\$2,981,566	\$4,879,036	\$3,008,628	

Student Amphitheater

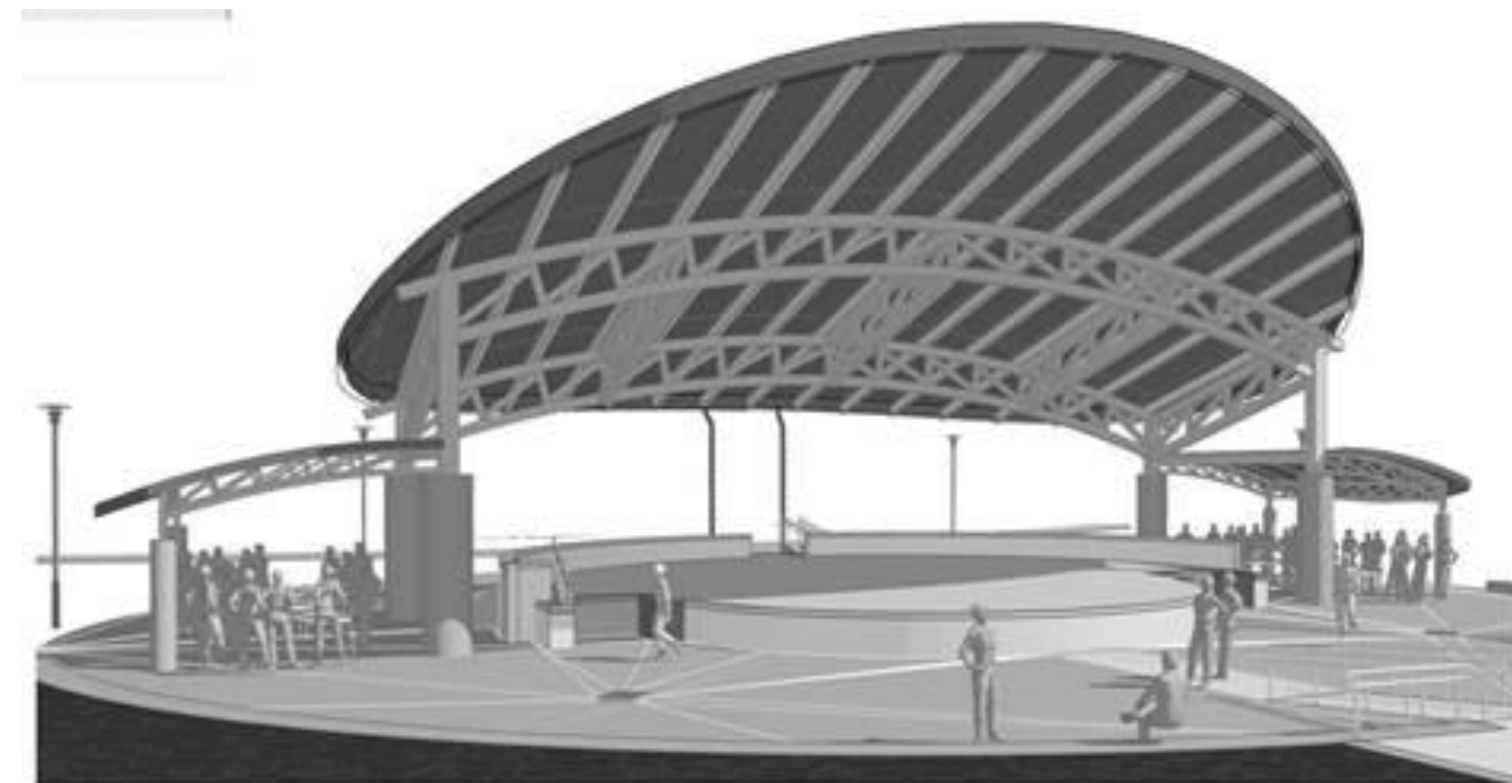

Student Amphitheater

Project Status Report:		Budget: \$2,727,934	Date: 8/20/2020	
Project #:	Project Name:	University Project Manager:	Project Status: On track with revised schedule	
CITF 2019	Student Amphitheater	David Rosenfeld		
Design Status (% Complete):	Designer:	Substantial Completion Date:		
100%	GRC Architects	Sep, 2020		
Construction Status (% Complete):	Contractor:	Occupancy Date:		
84%	RAM Construction	Oct, 2020		
Timely Completion Risk:		Severe weather (impact will be minimal), delivery of materials		
Mitigation Strategy:		None		
Project Contracts:	Expenses:	Encumbrances:	Remaining:	
\$2,227,934	\$1,516,624	\$165,483	\$90,605	

Information Item:
Duke Energy / Brooksville Update

FLORIDA **A&M** UNIVERSITY
Board of Trustees
INFORMATION ITEM

Budget, Finance and Facilities Committee

Wednesday, September 2, 2020

Agenda Item: VI

Subject: Duke Energy / Brooksville Update

Background Information and Summary:

Dr. Fred Gainous, Director of the Brooksville Agricultural and Environmental Research Station, will provide a summary and a brief update on the project.

Attachments: No

Information Item:
Housing Facilities Update

FLORIDA **A&M** UNIVERSITY
Board of Trustees
INFORMATION ITEM

Budget, Finance and Facilities Committee

Wednesday, September 2, 2020

Agenda Item: VII

Subject: Housing Facilities Update

Summary:

Dr. Jennifer Wilder, Director of University Housing will provide updates on student housing to include:

Palmetto South

Office Roof Replaced
Landscaping upgrades

Palmetto Phase III

Roofs replaced on all buildings

Polkinghorne Village

Reviewed the roof for signs of leakage and mildew in rooms- None found
Desk Replacement East & West
Select chair replacement Game Day Room

Sampson and Young

Exterior Painting

Gibbs

The building has been shutdown for renovations.

FAMU Towers

Opened on August 2, 2020

Attachments: No

Supplemental Document

List of Contracts > \$100,000



Florida Agricultural and Mechanical University

Contracts over \$100,000

1. Contractor: JSC Systems, Inc.

Contract #: C-ITB-0003-2020

Contract Start Date: July 1, 2020

Contract Expiration Date: January 1, 2021

Contract Amount: This amount will exceed \$100,000 over the term of the contract.

This contractor will replace the fire alarm system in the FAMU Perry-Paige Building, in accordance with the referenced contract, for the FAMU Housing Facilities, located in Tallahassee, Florida.